

CATALOG OF TABLED PRODUCTS

Aluminum extruded profiles

asa
alumínio



asa
aluminio

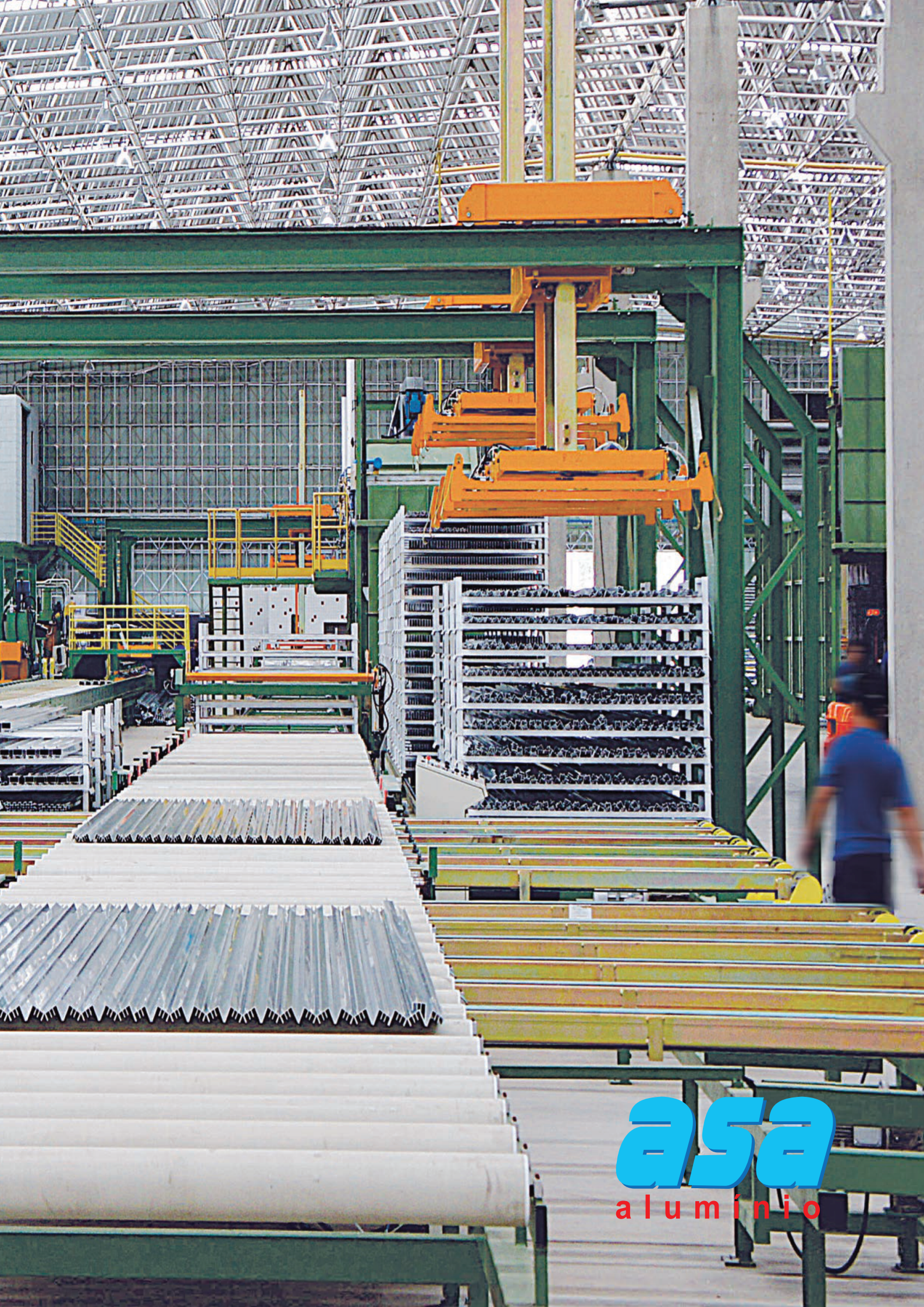

asa
aluminio

TABLED PROFILES

RODS

FLAT BARS

ANGLES

CHANNELS

TEE

I-BEAMS

TUBES

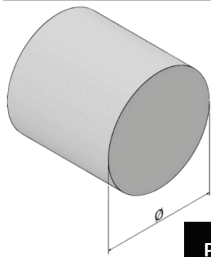

ROUND ROD

Profile	New Profile	Diameter Ø (mm)	Weight (Kg/m)
10038C	VER5.50	5,50	0,064
VER-0001	VER6.00	6,00	0,076
VER-0002	VER6.35	6,35	0,085
10002	VER6.80	6,80	0,098
10045C	VER7.00	7,00	0,104
10029C	VER7.14	7,14	0,108
10010	VER7.40	7,40	0,116
10032C	VER7.75	7,75	0,127
VER-0004	VER7.95	7,95	0,134
VER-0005	VER8.00	8,00	0,135
10019	VER8.20	8,20	0,143
10012	VER8.80	8,80	0,165
VER-0007	VER9.52	9,52	0,192
10021	VER10.10	10,10	0,217
VER-0124	VER10.70	10,70	0,243
10025C	VER10.80	10,80	0,248
VER-0009	VER11.11	11,11	0,262
10018	VER12.00	12,00	0,306
VER-0011	VER12.70	12,70	0,343
VER-0012	VER14.28	14,28	0,434
10036C	VER14.40	14,40	0,441
VER-0014	VER15.87	15,87	0,534
10028C	VER16.20	16,20	0,558
VER-0123	VER16.40	16,40	0,572
VER-0015	VER17.46	17,46	0,648
VER-0114	VER18.00	18,00	0,689
VER-0016	VER19.05	19,05	0,772
10026C	VER19.25	19,25	0,788
10040C	VER19.34	19,34	0,796
10007	VER21.20	21,20	0,953
VER-0018	VER22.23	22,23	1,052
10041C	VER22.36	22,36	1,064

Profile	New Profile	Diameter Ø (mm)	Weight (Kg/m)
10037C	VER23.00	23,00	1,126
VER-0020	VER23.81	23,81	1,206
10044C	VER24.00	24,00	1,226
10011	VER25.00	25,00	1,330
VER-0021	VER25.40	25,40	1,373
10-020	VER28.48	28,48	1,726
VER-0024	VER28.57	28,57	1,737
VER-0027	VER31.75	31,75	2,145
VER-0030	VER34.92	34,92	2,585
VER-0032	VER38.10	38,10	3,089
VER-0034	VER41.27	41,27	3,611
VER-0036	VER44.45	44,45	4,205
VER-0129	VER45.50	45,50	4,406
VER-0038	VER47.62	47,62	4,826
VER-0040	VER50.80	50,80	5,493
VER-0049	VER54.50	54,50	6,322
VER-0050	VER57.15	57,15	6,951
10014	VER61.85	61,85	8,142
VER-0042	VER63.50	63,50	8,583
VER-131	VER69.85	69,85	10,384
10016	VER72.00	72,00	11,033
VER-0043	VER76.20	76,20	12,358
10039C	VER82.55	82,55	14,504
VER-0044	VER88.90	88,90	16,821
10042C	VER95.25	95,25	19,310
VER-0045	VER101.60	101,60	21,970
10027E	VER114.30	114,30	27,806
VER-130	VER127.00	127,00	34,329
VER-132	VER152.40	152,40	49,434
VER-133	VER177.80	177,80	67,286
VER-136	VER203.20	203,20	87,883
VER-137	VER228.60	228,60	111,227

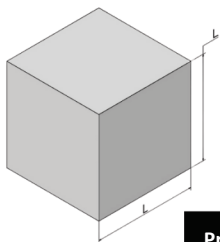

SQUARE ROD

SHARP CORNER WITH A RADIUS OF UP TO 0,5MM

Profile	New Profile	Width L (mm)	Weight (Kg/m)
VER-4002	VEQ6.35	6,35	0,109
VER-4003	VEQ7.93	7,93	0,170
VER-4006	VEQ9.53	9,53	0,245
VER-4007	VEQ11.11	11,11	0,334
VER-4008	VEQ12.70	12,70	0,435
VER-4011	VEQ15.88	15,88	0,682
VER-4013	VEQ19.05	19,05	0,983
VER-4015	VEQ22.22	22,22	1,333
VER-4017	VEQ25.40	25,40	1,741
VER-4018	VEQ28.57	28,57	2,211

Profile	New Profile	Width L (mm)	Weight (Kg/m)
VER-4019	VEQ31.75	31,75	2,762
VER-4022	VEQ38.10	38,10	3,933
VER-4024	VEQ44.45	44,45	5,334
VER-4026	VEQ50.80	50,80	6,993
BAR-4029	VEQ53.00	53,00	7,584
VER-4046	VEQ63.50	63,50	10,927
12-028	VEQ65.00	65,00	11,407
VER-4067	VEQ76.20	76,20	15,734
VER-4068	VEQ88.90	88,90	21,417
VER-4066	VEQ101.60	101,60	27,971

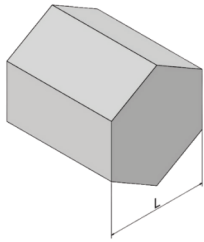

HEXAGONAL ROD

SHARP CORNER WITH A RADIUS OF UP TO 0,5MM

Profile	New Profile	Width L (mm)	Weight (Kg/m)
16-004C	VES6.35	6,35	0,095
16-003	VES7.20	7,20	0,121
VER-6002	VES7.94	7,94	0,147
VER-6003	VES9.52	9,52	0,212
VER-6004	VES11.11	11,11	0,292
VER-6005	VES12.70	12,70	0,378
VER-6006	VES14.00	14,00	0,492
VER-6007	VES15.87	15,87	0,588
VER-6008	VES17.50	17,50	0,712
VER-6009	VES19.05	19,05	0,854
VER-6011	VES22.30	22,30	1,166

Profile	New Profile	Width L (mm)	Weight (Kg/m)
VER-6012	VES23.82	23,81	1,331
VER-6013	VES25.40	25,40	1,527
VER-6014	VES26.98	26,98	1,708
VER-6015	VES28.50	28,50	1,900
VER-6016	VES30.16	30,20	2,134
VER-6017	VES31.75	31,75	2,365
VER-6019	VES34.93	34,93	2,863
VER-6021	VES38.10	38,10	3,376
VER-6023	VES41.27	41,27	3,998
VER-6030	VES63.50	63,50	9,463

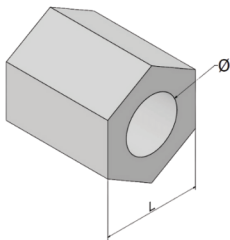

HEXAGONAL ROD WITH HOLE

SHARP CORNER WITH A RADIUS OF UP TO 0,5MM

Profile	New Profile	Width L (mm)	Diameter Ø (mm)	Weight (Kg/m)
78-1491C	VESF24.22X12.70	24,22	12,70	1,012
78-767	VESF25.40X9.60	25,40	9,60	1,317
78-768	VESF25.40X16.00	25,40	16,00	0,969
78-462	VESF28.58X15.00	28,58	15,00	1,421
78-648	VESF30.20X19.05	30,20	19,05	1,341
78-1492C	VESF30.57X19.10	30,57	19,10	1,396
78-766	VESF31.75X12.00	31,75	12,00	2,059
78-461	VESF34.93X19.05	34,93	19,05	2,066
78-650	VESF36.51X25.40	36,51	25,40	2,259
78-1487C	VESF36.95X25.40	36,95	25,40	1,775
78-769	VESF38.10X20.00	38,10	20,00	2,555

Profile	New Profile	Width L (mm)	Diameter Ø (mm)	Weight (Kg/m)
78-521	VESF41.28X25.40	41,28	25,40	2,605
78-1754C	VESF45.00X31.00	45,00	31,00	2,563
78-770	VESF50.80X25.00	50,80	25,00	4,726
78-1488C	VESF50.80X38.10	50,80	38,10	2,802
78-771	VESF57.15X31.00	57,15	31,00	5,619
78-1489C	VESF66.67X52.00	66,67	52,00	4,349
78-772	VESF69.85X41.00	69,85	41,00	7,872
78-1755C	VESF81.00X63.00	81,00	63,00	6,600
78-773	VESF88.90X52.00	88,90	52,00	12,792
78-1490D	VESF96.00X76.00	96,00	76,00	8,222

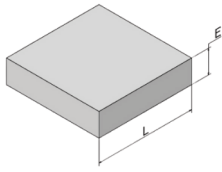

FLAT BAR

SHARP CORNER WITH A RADIUS OF UP TO 0,5MM

Profile	New Profile	Width L (mm)	Thickness E (mm)	Weight (Kg/m)
BAR-0084	BRCV9.52X6.35	9,52	6,35	0,163
12-130C	BRCV12.00X2.50	12,00	2,50	0,081
12-058	BRCV12.70X2.40	12,70	2,40	0,082
BAR-0012	BRCV12.70X3.18	12,70	3,18	0,109
BAR-0047	BRCV12.70X4.76	12,70	4,76	0,163
BAR-0086	BRCV12.70X6.35	12,70	6,35	0,218
12-108C	BRCV12.70X9.52	12,70	9,52	0,327
12-125C	BRCV15.60X2.60	15,60	2,60	0,109
12-025	BRCV15.88X2.00	15,88	2,00	0,085
12-024	BRCV15.88X2.40	15,88	2,40	0,102
BAR-0013	BRCV15.88X3.18	15,88	3,18	0,136
BAR-0049	BRCV15.88X4.76	15,88	4,76	0,204
BAR-0088	BRCV15.88X6.35	15,88	6,35	0,273
12-127C	BRCV17.00X13.00	17,00	13,00	0,598
12-001	BRCV17.80X1.80	17,80	1,80	0,086
12-094C	BRCV19.00X2.50	19,00	2,50	0,128
BAR-0014	BRCV19.05X3.18	19,05	3,18	0,164
BAR-0050	BRCV19.05X4.76	19,05	4,76	0,245
BAR-0089	BRCV19.05X6.35	19,05	6,35	0,327
BAR-0158	BRCV19.05X12.70	19,05	12,70	0,655
12-161C	BRCV19.35X3.18	19,35	3,18	0,166
12-115C	BRCV20.00X1.50	20,00	1,50	0,081
12-064	BRCV21.00X1.50	21,00	1,50	0,085
12-036	BRCV22.00X3.00	22,00	3,00	0,178
12-045	BRCV22.00X3.70	22,00	3,70	0,220
BAR-0052	BRCV22.22X4.76	22,22	4,76	0,286
BAR-0090	BRCV22.22X6.35	22,22	6,35	0,382
BAR-0015	BRCV22.23X3.18	22,23	3,18	0,191
12-055	BRCV23.00X1.50	23,00	1,50	0,093
12-141C	BRCV23.00X4.50	23,00	4,50	0,279
12-098C	BRCV23.80X1.25	23,80	1,25	0,080
12-048	BRCV24.00X4.00	24,00	4,00	0,259
12-099C	BRCV24.00X4.50	24,00	4,50	0,292
12-117C	BRCV24.00X11.00	24,00	11,00	0,714
12-074	BRCV25.00X8.00	25,00	8,00	0,540
BAR-0002	BRCV25.40X1.60	25,40	1,60	0,109
12-093C	BRCV25.40X2.40	25,40	2,40	0,164
BAR-0016	BRCV25.40X3.18	25,40	3,18	0,218
12-042	BRCV25.40X3.76	25,40	3,76	0,257
12-091C	BRCV25.40X4.50	25,40	4,50	0,309
BAR-0053	BRCV25.40X4.76	25,40	4,76	0,327
BAR-0091	BRCV25.40X6.35	25,40	6,35	0,436
BAR-0160	BRCV25.40X12.70	25,40	12,70	0,873
12-165C	BRCV25.40X15.88	25,40	15,88	1,093
12-173C	BRCV25.40X17.50	25,40	17,50	1,204
12-052	BRCV27.00X2.00	27,00	2,00	0,146
12-051	BRCV27.00X5.00	27,00	5,00	0,365
12-131C	BRCV30.00X2.00	30,00	2,00	0,162
12-133C	BRCV30.00X15.00	30,00	15,00	1,218

Profile	New Profile	Width L (mm)	Thickness E (mm)	Weight (Kg/m)
12-116C	BRCV30.80X1.50	30,80	1,50	0,124
12-081C	BRCV31.10X2.90	31,10	2,90	0,243
BAR-0320	BRCV31.50X16.50	31,50	16,50	1,409
BAR-0019	BRCV31.75X3.18	31,75	3,18	0,271
BAR-0054	BRCV31.75X4.80	31,75	4,80	0,409
BAR-0132	BRCV31.75X9.50	31,75	9,50	0,816
BAR-0093	BRCV31.80X6.40	31,80	6,40	0,546
12-135C	BRCV32.00X8.00	32,00	8,00	0,693
12-090C	BRCV37.00X2.00	37,00	2,00	0,199
12-184C	BRCV38.10X3.18	38,10	2,00	0,206
BAR-0022	BRCV38.10X3.18	38,10	3,18	0,328
BAR-0057	BRCV38.10X4.76	38,10	4,76	0,491
BAR-0096	BRCV38.10X6.35	38,10	6,35	0,655
BAR-0134	BRCV38.10X9.52	38,10	9,52	0,980
BAR-0164	BRCV38.10X12.70	38,10	12,70	1,311
BAR-0208	BRCV38.10X15.87	38,10	15,87	1,638
12-177C	BRCV38.10X19.05	38,10	19,05	1,967
BAR-0382	BRCV38.10X25.40	38,10	25,40	2,622
12-139C	BRCV39.00X4.00	39,00	4,00	0,422
12-104C	BRCV40.00X8.00	40,00	8,00	0,866
12-033	BRCV40.00X8.85	40,00	8,85	0,959
12-034	BRCV40.00X25.00	40,00	25,00	2,709
12-084C	BRCV41.28X26.98	41,28	26,98	3,017
12-122C	BRCV42.50X3.20	42,50	3,20	0,368
12-109C	BRCV43.00X1.70	43,00	1,70	0,197
12-146C	BRCV43.20X3.00	43,20	3,00	0,350
12-041	BRCV44.40X3.00	44,40	3,00	0,360
12-132C	BRCV44.45X15.90	44,45	15,90	1,914
12-134C	BRCV45.00X8.00	45,00	8,00	0,975
12-107C	BRCV45.00X32.00	45,00	32,00	3,899
12-030	BRCV46.00X26.00	46,00	26,00	3,240
12-103C	BRCV50.00X8.00	50,00	8,00	1,083
12-137C	BRCV50.00X14.00	50,00	14,00	1,896
BAR-0387	BRCV50.80X1.50	50,80	1,50	0,206
BAR-0027	BRCV50.80X3.18	50,80	3,18	0,437
BAR-0061	BRCV50.80X4.76	50,80	4,76	0,652
BAR-0100	BRCV50.80X6.35	50,80	6,35	0,873
BAR-0137	BRCV50.80X9.50	50,80	9,50	1,306
BAR-0168	BRCV50.80X12.70	50,80	12,70	1,741
BAR-0198	BRCV50.80X15.87	50,80	15,87	2,184
BAR-0189	BRCV50.80X19.05	50,80	19,05	2,622
BAR-0194	BRCV50.80X25.40	50,80	25,40	3,496
12-168C	BRCV50.80X31.75	50,80	31,75	4,371
12-176C	BRCV50.80X38.10	50,80	38,10	5,245
12-013	BRCV52.00X37.00	52,00	37,00	5,194
12-039	BRCV53.00X40.00	53,00	40,00	5,744
12-082C	BRCV55.00X1.40	55,00	1,40	0,208
12-172C	BRCV59.30X3.00	59,30	3,00	0,482
BAR-4030	BRCV60.00X10.00	60,00	10,00	1,625

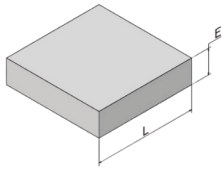

FLAT BAR

SHARP CORNER WITH A RADIUS OF UP TO 0,5MM

Profile	New Profile	Width L (mm)	Thickness E (mm)	Weight (Kg/m)
12-021	BRCV60.00X20.00	60,00	20,00	3,240
12-061	BRCV60.00X30.00	60,00	30,00	4,877
12-010	BRCV60.50X2.00	60,50	2,00	0,327
12-026	BRCV61.00X2.20	61,00	2,20	0,363
12-145C	BRCV63.00X3.00	63,00	3,00	0,511
BAR-0030	BRCV63.50X3.20	63,50	3,20	0,546
BAR-0064	BRCV63.50X4.76	63,50	4,76	0,818
BAR-0104	BRCV63.50X6.35	63,50	6,35	1,088
BAR-0141	BRCV63.50X9.52	63,50	9,52	1,630
BAR-0172	BRCV63.50X12.70	63,50	12,70	2,185
12-142C	BRCV63.50X15.87	63,50	15,87	2,730
BAR-0314	BRCV63.50X25.40	63,50	25,40	4,370
12-164C	BRCV63.50X31.75	63,50	31,75	5,464
12-178C	BRCV63.50X38.10	63,50	38,10	6,556
12-027	BRCV65.00X53.00	65,00	53,00	9,300
12-174C	BRCV70.00X4.40	70,00	4,40	0,834
12-006	BRCV70.00X5.00	70,00	5,00	0,945
12-157C	BRCV70.00X7.80	70,00	7,80	1,480
12-175C	BRCV70.00X45.00	70,00	45,00	8,536
12-008	BRCV72.00X2.50	72,00	2,50	0,487
12-007	BRCV76.00X4.00	76,00	4,00	0,820
BAR-0032	BRCV76.20X3.17	76,20	3,17	0,652
BAR-0106	BRCV76.20X6.35	76,20	6,35	1,306
12-088C	BRCV76.20X7.94	76,20	7,94	1,639
BAR-0144	BRCV76.20X9.52	76,20	9,52	1,966
BAR-0175	BRCV76.20X12.70	76,20	12,70	2,622
BAR-0330	BRCV76.20X15.90	76,20	15,90	3,283
BAR-0191	BRCV76.20X25.40	76,20	25,40	5,225
BAR-0397	BRCV76.20X31.75	76,20	31,75	6,556
BAR-0193	BRCV76.20X38.10	76,20	38,10	7,867
12-182C	BRCV76.20X50.80	76,20	50,80	10,490
12-029	BRCV80.00X3.18	80,00	3,18	0,685
12-095C	BRCV85.00X4.00	85,00	4,00	0,920
12-002	BRCV88.50X3.50	88,50	3,50	0,836
12-016	BRCV88.90X4.76	88,90	4,76	1,142
BAR-0108	BRCV88.90X6.35	88,90	6,35	1,529
12-076	BRCV88.90X63.50	88,90	63,50	15,298
12-136C	BRCV90.50X37.00	90,50	37,00	9,073
12-020	BRCV92.00X51.00	92,00	51,00	12,715
12-019	BRCV100.00X3.00	100,00	3,00	0,812
12-012	BRCV100.00X8.00	100,00	8,00	2,160
12-087C	BRCV100.00X8.50	100,00	8,50	2,302
BAR-0186	BRCV100.00X15.00	100,00	15,00	4,050
BAR-0110	BRCV101.60X6.35	101,60	6,35	1,741
BAR-0149	BRCV101.60X9.52	101,60	9,52	2,620
BAR-0403	BRCV101.60X15.88	101,60	15,88	4,371
BAR-0404	BRCV101.60X19.05	101,60	19,05	5,244
BAR-405	BRCV101.60X25.40	101,60	25,40	6,992
12-183C	BRCV101.60X31.75	101,60	31,75	8,741

Profile	New Profile	Width L (mm)	Thickness E (mm)	Weight (Kg/m)
BAR-0407	BRCV101.60X38.10	101,60	38,10	10,490
BAR-0180	BRCV101.80X12.70	101,60	12,70	3,483
12-123C	BRCV104.00X12.00	104,00	12,00	3,381
12-009	BRCV110.00X3.00	110,00	3,00	0,894
12-011	BRCV110.00X6.00	110,00	6,00	1,788
12-017	BRCV120.00X4.00	120,00	4,00	1,296
12-128C	BRCV120.00X12.00	120,00	12,00	3,902
BAR-0413	BRCV125.00X4.76	125,00	4,76	1,612
12-015	BRCV125.00X42.00	125,00	42,00	14,227
BAR-0151	BRCV127.00X9.52	127,00	9,52	3,275
BAR-0182	BRCV127.00X12.70	127,00	12,70	4,370
BAR-414	BRCV127.00X15.88	127,00	15,88	5,464
12-044	BRCV127.00X16.00	127,00	16,00	5,506
12-086C	BRCV127.00X19.05	127,00	19,05	6,555
BAR-0192	BRCV127.00X25.40	127,00	25,40	8,741
12-180C	BRCV127.00X38.10	127,00	38,10	13,113
12-179C	BRCV127.00X50.80	127,00	50,80	17,484
12-152C	BRCV133.00X4.20	133,00	4,20	1,512
12-004	BRCV133.35X4.76	133,35	4,76	1,720
12-057	BRCV135.00X40.50	135,00	40,50	14,816
12-124C	BRCV137.00X6.35	137,00	6,35	2,356
BAR-0183	BRCV139.70X12.70	139,70	12,70	4,790
12-018	BRCV150.00X4.00	150,00	4,00	1,625
BAR-0114	BRCV152.40X6.35	152,40	6,35	2,622
BAR-0184	BRCV152.40X12.70	152,40	12,70	5,244
12-063	BRCV152.40X15.88	152,40	15,88	6,558
12-101D	BRCV152.40X19.05	152,40	19,05	7,867
12-100D	BRCV152.40X25.40	152,40	25,40	10,490
12-181C	BRCV152.40X31.75	152,40	31,75	13,133
12-105D	BRCV160.00X12.70	160,00	12,70	5,506
12-138C	BRCV177.80X9.53	177,80	9,53	4,591
12-106D	BRCV190.00X12.70	190,00	12,70	6,539
12-037	BRCV203.20X12.70	203,20	12,70	6,993
BAR-0196	BRCV203.20X15.88	203,20	15,88	8,741
12-075	BRCV207.00X45.00	207,00	45,00	25,243
12-032	BRCV213.00X20.00	213,00	20,00	11,544
12-150C	BRCV228.00X6.00	228,00	6,00	3,710
12-151C	BRCV228.00X8.00	228,00	8,00	4,950
12-147C	BRCV230.00X15.88	230,00	15,88	9,897
12-189D	BRCV240.00X12.70	240,00	12,70	8,260
12-148C	BRCV240.00X15.88	240,00	15,88	10,327
12-149C	BRCV270.00X26.00	270,00	26,00	19,010
12-129E	BRCV280.00X15.80	280,00	15,80	11,988
12-188E	BRCV290.00X12.70	290,00	12,70	9,981
12-163E	BRCV300.00X10.00	300,00	10,00	8,130
12-187E	BRCV300.00X31.75	300,00	31,75	25,815
12-186E	BRCV310.00X16.00	310,00	16,00	13,442
12-185E	BRCV310.00X20.00	310,00	20,00	16,802
12-167E	BRCV350.00X12.70	350,00	12,70	12,046

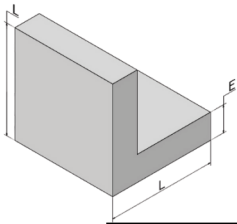

ANGLES EQUAL LEGS

SHARP CORNER WITH A RADIUS OF UP TO 0,5MM

Profile	New Profile	Width L (mm)	Thickness E (mm)	Weight (Kg/m)
L-002	PLI12.70X1.58	12,70	1,58	0,101
L-405	PLI15.88X1.58	15,88	1,58	0,128
20-008	PLI15.88X3.18	15,88	3,18	0,245
20-019C	PLI19.05X1.20	19,05	1,20	0,119
L-009	PLI19.05X1.59	19,05	1,59	0,157
L-010	PLI19.05X2.40	19,05	2,40	0,231
L-011	PLI19.05X3.18	19,05	3,18	0,300
20-013	PLI22.20X1.60	22,20	1,60	0,184
L-249	PLI22.23X2.38	22,23	2,38	0,271
L-012	PLI22.23X3.18	22,23	3,18	0,355
L-741	PLI25.40X1.20	25,40	1,20	0,161
L-013	PLI25.40X1.59	25,40	1,59	0,211
L-0014	PLI25.40X3.20	25,40	3,20	0,410
L-015	PLI25.40X4.80	25,40	4,80	0,598
20-352C	PLI30.00X3.00	30,00	3,00	0,463
20-006	PLI31.75X1.58	31,75	1,58	0,264
L-018	PLI31.75X3.20	31,75	3,20	0,522
L-019	PLI31.75X4.76	31,75	4,76	0,757
20-018C	PLI35.00X1.50	35,00	1,50	0,277
L-744	PLI38.10X1.59	38,10	1,59	0,320
23-022	PLI38.10X2.00	38,10	2,00	0,401
L-022	PLI38.10X3.18	38,10	3,18	0,629

Profile	New Profile	Width L (mm)	Thickness E (mm)	Weight (Kg/m)
L-023	PLI38.10X4.76	38,10	4,76	0,921
20-349C	PLI40.00X4.00	40,00	4,00	0,823
20-022C	PLI50.00X4.00	50,00	4,00	1,040
20-017C	PLI50.80X1.58	50,80	1,58	0,427
L-612	PLI50.80X2.00	50,80	2,00	0,539
L-336	PLI50.80X2.50	50,80	2,50	0,670
L-025	PLI50.80X3.20	50,80	3,20	0,850
L-026	PLI50.80X4.75	50,80	4,75	1,246
L-027	PLI50.80X6.35	50,80	6,35	1,639
L-457	PLI63.50X3.18	63,50	3,18	1,065
L-029	PLI63.50X6.35	63,50	6,35	2,075
20-005	PLI70.00X2.00	70,00	2,00	0,745
20-003	PLI70.00X4.00	70,00	4,00	1,496
20-004	PLI76.00X3.35	76,00	3,35	1,344
L-748	PLI76.20X4.77	76,20	4,77	1,908
L-749	PLI76.20X6.35	76,20	6,35	2,512
20-011	PLI76.20X7.40	76,20	7,40	2,907
20-353C	PLI76.20X12.00	76,20	12,00	4,566
20-016C	PLI101.60X12.70	101,60	12,70	6,555
20-010	PLI102.00X6.40	102,00	6,40	3,426
20-020E	PLI152.40X7.94	152,40	7,94	6,385

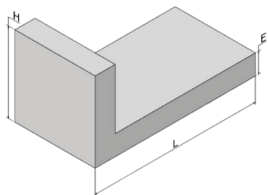

ANGLES UNEQUAL LEGS

SHARP CORNER WITH A RADIUS OF UP TO 0,5MM

Profile	New Profile	L-Long H (mm)	L-Short L (mm)	Thickness E (mm)	Weight (Kg/m)
23-024	PLD12.00X7.50X2.00	12,00	7,50	2,00	0,094
23-021	PLD16.80X9.80X1.80	16,80	9,80	1,80	0,120
23-013	PLD19.00X8.00X1.50	19,00	8,00	1,50	0,103
23-025	PLD20.00X10.00X1.20	20,00	10,00	1,20	0,093
23-046C	PLD21.00X12.80X1.20	21,00	12,80	1,20	0,105
23-015	PLD21.00X13.00X2.00	21,00	13,00	2,00	0,173
23-027	PLD25.00X17.50X2.40	25,00	17,50	2,40	0,260
L-093	PLD25.40X12.70X3.18	25,40	12,70	3,18	0,300
L-090	PLD25.40X19.05X3.20	25,40	19,05	3,20	0,357
23-029	PLD27.00X8.00X2.50	27,00	8,00	2,50	0,219
23-006	PLD28.00X20.00X4.76	28,00	20,00	4,76	0,555
L-434	PLD30.00X20.00X1.60	30,00	20,00	1,60	0,209
L-768	PLD32.00X6.00X2.00	32,00	6,00	2,00	0,194
23-014	PLD35.00X22.00X2.00	35,00	22,00	2,00	0,297
23-001	PLD38.10X15.80X2.38	38,10	15,80	2,38	0,331
L-100	PLD38.10X25.40X3.18	38,10	25,40	3,18	0,519
L-040	PLD44.45X31.75X4.76	44,45	31,75	4,76	0,921
23-016	PLD50.00X14.00X2.00	50,00	14,00	2,00	0,335
L-776	PLD50.80X12.70X3.18	50,80	12,70	3,18	0,518
L-104	PLD50.80X25.40X3.18	50,80	25,40	3,18	0,628

Profile	New Profile	L-Long H (mm)	L-Short L (mm)	Thickness E (mm)	Weight (Kg/m)
L-105	PLD50.80X25.40X4.76	50,80	25,40	4,76	0,921
L-668	PLD50.80X31.75X2.00	50,80	31,75	2,00	0,436
23-035C	PLD51.00X18.00X4.00	51,00	18,00	4,00	0,704
23-049C	PLD60.00X35.00X1.30	60,00	35,00	1,30	0,330
23-004	PLD60.00X35.00X1.58	60,00	35,00	1,58	0,400
L-054	PLD63.00X51.30X6.35	63,00	51,30	6,35	1,857
L-070	PLD88.90X76.20X6.35	88,90	76,20	6,35	2,731
23-059C	PLD90.00X60.00X3.00	90,00	60,00	3,00	1,195
23-040C	PLD90.00X60.00X4.00	90,00	60,00	4,00	1,582
23-048C	PLD94.30X30.00X1.30	94,30	30,00	1,30	0,433
23-002	PLD94.30X30.00X1.60	94,30	30,00	1,60	0,531
23-039C	PLD101.60X50.80X4.76	101,60	50,80	4,76	1,903
23-032C	PLD120.00X31.00X3.00	120,00	31,00	3,00	1,202
23-058C	PLD120.00X60.00X3.00	120,00	60,00	3,00	1,439
23-044C	PLD120.00X60.00X4.00	120,00	60,00	4,00	1,907
23-010	PLD125.00X50.00X2.00	125,00	50,00	2,00	0,933
23-043C	PLD150.00X60.00X4.00	150,00	60,00	4,00	2,232
23-023	PLD150.00X60.00X7.94	150,00	60,00	7,94	4,347
23-031	PLD200.00X50.00X6.00	200,00	50,00	6,00	3,967
23-045C	PLD220.00X70.00X5.00	220,00	70,00	5,00	3,861

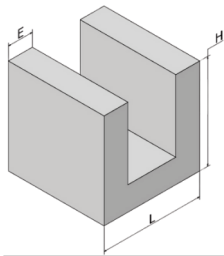

CHANNELS

SHARP CORNER WITH A RADIUS OF UP TO 0,5MM

Profile	New Profile	Width L (mm)	Height H (mm)	Thickness E (mm)	Weight (Kg/m)
31-001	PU6.35X6.35X1.60	6,35	6,35	1,60	0,068
31-086C	PU8.50X10.50X1.20	8,50	10,50	1,20	0,087
U-0841	PU9.50X9.50X1.20	9,50	9,50	1,20	0,085
U-0037	PU9.50X12.70X1.60	9,50	12,70	1,60	0,137
U-0036	PU9.52X9.52X1.60	9,52	9,52	1,60	0,110
31-037	PU11.00X15.00X1.20	11,00	15,00	1,20	0,125
31-020	PU11.20X15.00X1.10	11,20	15,00	1,10	0,116
31-132C	PU12.50X14.00X2.20	12,50	14,00	2,20	0,215
U-0044	PU12.70X12.70X1.60	12,70	12,70	1,60	0,151
U-0306	PU12.70X12.70X3.17	12,70	12,70	3,17	0,270
31-041	PU13.00X13.00X1.30	13,00	13,00	1,30	0,128
31-036	PU13.90X15.00X1.20	13,90	15,00	1,20	0,134
U-0555A	PU14.20X25.00X1.20	14,20	25,00	1,20	0,200
31-007	PU14.40X12.70X1.20	14,40	12,70	1,20	0,121
U-0555	PU15.00X25.00X1.60	15,00	25,00	1,60	0,267
31-046	PU15.50X25.40X2.35	15,50	25,40	2,35	0,392
U-0048	PU15.88X9.52X2.40	15,88	9,52	2,40	0,195
U-0049	PU15.88X15.88X2.40	15,88	15,88	2,40	0,278
U-0509	PU15.90X15.90X1.60	15,90	15,90	1,60	0,193
31-003	PU16.00X16.00X2.00	16,00	16,00	2,00	0,237
31-061D	PU17.00X42.00X1.40	17,00	42,00	1,40	0,372
31-022	PU19.05X31.75X2.38	19,05	31,75	2,38	0,502
U-0061	PU20.00X15.00X1.50	20,00	15,00	1,50	0,191
31-016	PU20.20X25.40X1.40	20,20	25,40	1,40	0,240
31-039	PU20.30X5.80X1.80	20,30	5,80	1,80	0,137
31-025	PU21.70X8.00X2.50	21,70	8,00	2,50	0,221
U-1168	PU22.00X22.00X1.90	22,00	22,00	1,90	0,320
U-0064	PU22.20X22.20X2.38	22,20	22,20	2,38	0,397
31-062C	PU24.10X11.80X1.00	24,10	11,80	1,00	0,123
31-048	PU24.70X28.30X1.10	24,70	28,30	1,10	0,235
31-083C	PU25.00X22.00X1.00	25,00	22,00	1,00	0,181
31-064C	PU25.40X12.70X3.18	25,40	12,70	3,18	0,382
31-082C	PU25.40X25.40X2.38	25,40	25,40	2,38	0,460
U-070	PU25.40X25.40X3.20	25,40	25,40	3,20	0,604

Profile	New Profile	Width L (mm)	Height H (mm)	Thickness E (mm)	Weight (Kg/m)
31-119C	PU25.40X50.80X3.18	25,40	50,80	3,18	1,040
31-118C	PU30.00X30.00X3.00	30,00	30,00	3,00	0,683
31-057C	PU30.40X39.90X1.50	30,40	39,90	1,50	0,435
31-002	PU31.75X31.75X2.00	31,75	31,75	2,00	0,492
31-018	PU29.00X35.00X1.50	29,00	35,00	1,50	0,388
31-006	PU36.00X11.00X1.30	36,00	11,00	1,30	0,194
31-029	PU38.00X38.00X2.00	38,00	38,00	2,00	0,596
U-1216	PU38.10X12.70X1.50	38,10	12,70	1,50	0,245
31-004	PU38.10X12.70X1.80	38,10	12,70	1,80	0,291
U-0082	PU38.10X12.70X2.38	38,10	12,70	2,38	0,378
U-1217	PU38.10X25.40X2.00	38,10	25,40	2,00	0,458
31-009	PU40.00X25.00X3.50	40,00	25,00	3,50	0,784
31-069C	PU40.00X30.00X1.40	40,00	30,00	1,40	0,368
31-068C	PU40.00X40.00X1.40	40,00	40,00	1,40	0,444
31-060C	PU42.00X32.00X1.60	42,00	32,00	1,60	0,445
U-501	PU43.60X30.00X1.80	43,60	30,00	1,80	0,487
31-067C	PU44.00X38.00X1.50	44,00	38,00	1,50	0,475
31-074C	PU44.00X50.00X1.50	44,00	50,00	1,50	0,572
31-040	PU45.00X45.00X1.60	45,00	45,00	1,60	0,570
U-1184	PU50.00X25.00X2.00	50,00	25,00	2,00	0,518
31-103C	PU50.00X100.00X5.00	50,00	100,00	5,00	3,114
U-0732	PU50.80X25.40X3.15	50,80	25,40	3,15	0,810
31-117C	PU60.00X35.00X2.00	60,00	35,00	2,00	0,683
31-088C	PU73.60X10.80X1.20	73,60	10,80	1,20	0,301
U-0092	PU80.00X32.00X2.00	80,00	32,00	2,00	0,756
31-015	PU85.00X60.00X2.50	85,00	60,00	2,50	1,350
31-065C	PU100.00X40.00X4.00	100,00	40,00	4,00	1,864
U-0093	PU101.60X50.80X3.15	101,60	50,80	3,15	1,680
31-014	PU102.60X25.00X1.30	102,60	25,00	1,30	0,526
31-008	PU107.00X47.50X2.50	107,00	47,50	2,50	1,329
31-121D	PU150.00X50.00X3.00	150,00	50,00	3,00	1,984
31-023	PU160.00X40.00X2.50	160,00	40,00	2,50	1,592
31-024	PU183.00X15.00X2.00	183,00	15,00	2,00	1,132
31-058E	PU239.60X40.00X4.80	239,60	40,00	4,80	4,031

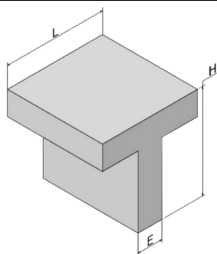

TEE

SHARP CORNER WITH A RADIUS OF UP TO 0,5MM

Profile	New Profile	Width L (mm)	Height H (mm)	Thickness E (mm)	Weight (Kg/m)
50-025	PT19.00X19.00X1.58	19,00	19,00	1,58	0,155
50-005	PT25.00X25.00X1.50	25,00	25,00	1,50	0,195
T-123	PT25.40X25.40X1.20	25,40	25,40	1,20	0,161
50-016	PT26.00X35.00X3.00	26,00	35,00	3,00	0,471
T-018	PT31.75X31.75X3.20	31,75	31,75	3,20	0,522

Profile	New Profile	Width L (mm)	Height H (mm)	Thickness E (mm)	Weight (Kg/m)
T-021	PT38.10X38.10X3.20	38,10	38,10	3,20	0,630
50-003	PT50.00X75.00X4.00	50,00	75,00	4,00	1,306
50-038E	PT63.50X228.60X9.52	63,50	228,60	9,52	7,289
50-049C	PT80.00X61.80X1.80	80,00	61,80	1,80	0,683
50-046C	PT85.00X75.00X4.00	85,00	75,00	4,00	1,690

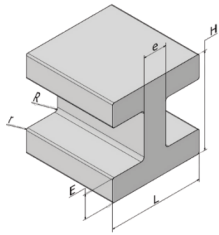

I-BEAMS

Profile	New Profile	Width L (mm)	Thickness E (mm)	Height H (mm)	Thickness e (mm)	Radius R (mm)	Radius r (mm)	Weight (Kg/m)
44-047C	PI17.00X1.50X28.00X1.50	17,00	1,50	28,00	1,50	0,50	0,50	0,239
44-007	PI32.00X1.50X9.50X8.00	32,00	1,50	9,50	8,00	0,50	0,50	0,400
44-056C	PI33.00X2.50X75.00X2.00	33,00	2,50	75,00	2,00	1,00	1,00	0,827
44-059C	PI35.50X2.00X35.50X2.00	35,50	2,00	35,50	2,00	1,00	0,30	0,557
44-034	PI38.10X4.00X25.40X4.00	38,10	4,00	25,40	4,00	0,30	0,30	1,014
44-069C	PI40.00X3.00X50.00X3.00	40,00	3,00	50,00	3,00	2,00	1,50	1,006
44-042	PI52.00X3.30X52.00X3.00	52,00	3,30	52,00	3,00	0,30	0,30	1,296
44-022	PI61.60X1.60X24.20X1.60	61,60	1,60	24,20	1,60	0,30	0,30	0,625
44-054C	PI63.00X1.40X33.30X2.00	63,00	1,40	33,30	2,00	0,30	0,30	0,643
44-062C	PI80.00X6.00X200.00X4.00	80,00	6,00	200,00	4,00	3,00	0,50	4,659
44-079E	PI125.40X9.00X203.00X6.00	125,40	9,00	203,00	6,00	8,00	0,30	9,274
44-078E	PI140.00X12.00X305.00X7.40	140,00	12,00	305,00	7,40	10,00	0,30	14,973
44-055E	PI150.00X20.00X150.00X20.00	150,00	20,00	150,00	20,00	5,00	3,00	22,238
44-070C	PI152.40X8.00X152.40X8.00	152,40	8,00	152,40	8,00	2,50	1,00	9,575
44-060C	PI152.40X12.70X152.40X9.53	152,40	12,70	152,40	9,53	15,87	1,00	14,351
44-053D	PI152.40X12.70X152.40X12.70	152,40	12,70	152,40	12,70	0,50	0,50	14,860
44-058E	PI164.00X20.00X200.00X20.00	164,00	20,00	200,00	20,00	10,00	2,00	26,663

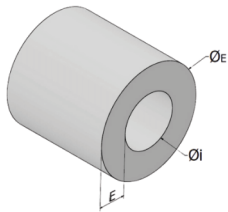

ROUND TUBE - SCHEDULE

CHECK DIMENSION ACCURACY

Profile	New Profile	Diameter Nominal Ø (pol)	Schedule	Diameter Øe (mm)	Diameter Øi (mm)	Thickness E (mm)	Weight (Kg/m)
TUB-0034	TR21.34X2.77	1/2"	40	21,34	15,80	2,77	0,436
72-332C	TR21.30X3.73	1/2"	80	21,30	13,84	3,73	0,557
TUB-0050	TR26.67X2.87	3/4"	40	26,67	20,93	2,87	0,579
TUB-0066	TR33.00X3.38	1"	40	33,40	26,64	3,38	0,860
TUB-067	TR33.40X4.55	1"	80	33,40	24,30	4,55	1,118
TUB-0075	TR42.17X3.56	1.1/4"	40	42,17	35,05	3,56	1,165
TUB-0088	TR48.26X3.68	1.1/2"	40	48,26	40,90	3,68	1,396
TUB-0089	TR48.26X5.08	1.1/2"	80	48,26	38,10	5,08	1,868
TUB-0100	TR60.33X3.91	2"	40	60,33	52,51	3,91	1,878
TUB-0101	TR60.33X5.54	2"	80	60,33	49,25	5,54	2,584
TUB-602	TR60.33X8.71	2"	160	60,33	42,91	8,71	3,829
TUB-0109	TR73.03X5.16	2.1/2"	40	73,03	62,71	5,16	2,981
TUB-0110	TR73.03X7.01	2.1/2"	80	73,03	59,01	7,01	3,925
TUB-0117	TR88.90X5.50	3"	40	88,90	77,90	5,50	3,898
TUB-0118	TR88.90X7.62	3"	80	88,90	73,66	7,62	5,273
TUB-0122	TR101.60X5.74	3.1/2"	40	101,60	90,12	5,74	4,791
TUB-0123	TR101.60X8.08	3.1/2"	80	101,60	85,44	8,08	6,433
72-323C	TR114.30X3.05	4"	10	114,30	108,20	3,05	2,888
TUB-0125	TR114.30X6.02	4"	40	114,30	102,26	6,02	5,549
TUB-0127	TR114.30X8.56	4"	80	114,30	97,18	8,56	7,706
TUB-0611	TR114.30X13.49	4"	160	114,30	87,33	13,49	11,574
TUB-0132	TR141.30X6.55	5"	40	141,30	128,20	6,55	7,514
TUB-133	TR141.30X9.52	5"	80	141,30	122,26	9,52	10,680
TUB-0135	TR168.28X7.11	6"	40	168,28	154,06	7,11	9,756
72-384E	TR168.28X10.98	6"	80	168,28	146,33	10,98	14,698
TUB-650C	TR219.10X8.20	8"	40	219,10	202,70	8,20	14,687

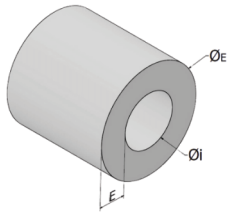

ROUND TUBE

Profile	New Profile	Diameter Ø _e (mm)	Diameter Ø _i (mm)	Thickness E (mm)	Weight (Kg/m)
72-151	TR8.00X1.50	8,00	5,00	1,50	0,083
TUB-0001	TR9.52X1.00	9,52	7,52	1,00	0,072
72-124	TR9.52X2.66	9,52	4,20	2,66	0,154
TUB-0003	TR9.53X1.59	9,53	6,35	1,59	0,107
72-109	TR10.00X1.10	10,00	7,80	1,10	0,083
72-076	TR10.00X1.50	10,00	7,00	1,50	0,108
72-289C	TR12.50X1.15	12,50	10,20	1,15	0,110
TUB-0008	TR12.70X1.00	12,70	10,70	1,00	0,100
TUB-0009	TR12.70X1.24	12,70	10,22	1,24	0,120
TUB-0010	TR12.70X1.59	12,70	9,52	1,59	0,150
TUB-0011	TR12.70X2.00	12,70	8,70	2,00	0,182
72-372C	TR12.70X3.18	12,70	6,34	3,18	0,257
72-308C	TR14.00X1.50	14,00	11,00	1,50	0,159
72-255	TR15.00X1.00	15,00	13,00	1,00	0,119
72-016	TR15.00X2.65	15,00	9,70	2,65	0,278
72-214	TR15.50X1.50	15,50	12,50	1,50	0,178
TUB-0021	TR15.80X3.20	15,80	9,40	3,20	0,343
72-309C	TR15.87X1.30	15,87	13,27	1,30	0,161
TUB-0017	TR15.88X1.00	15,88	13,88	1,00	0,126
TUB-0018	TR15.88X1.24	15,88	13,40	1,24	0,153
TUB-0019	TR15.88X1.59	15,88	12,70	1,59	0,192
TUB-0020	TR15.88X2.38	15,88	11,12	2,38	0,270
72-293C	TR15.90X1.20	15,90	13,50	1,20	0,150
72-274	TR17.00X2.00	17,00	13,00	2,00	0,255
72-130	TR17.50X3.25	17,50	11,00	3,25	0,392
72-313C	TR18.40X1.50	18,40	15,40	1,50	0,215
72-254	TR18.50X1.58	18,50	15,34	1,58	0,227
TUB-0026	TR19.05X1.00	19,05	17,05	1,00	0,153
TUB-0027	TR19.05X1.24	19,05	16,57	1,24	0,188
72-361C	TR19.05X1.40	19,05	16,25	1,40	0,210
72-321C	TR19.05X1.50	19,05	16,05	1,50	0,224
TUB-0028	TR19.05X1.59	19,05	15,87	1,59	0,236
TUB-0544	TR19.05X2.50	19,05	14,05	2,50	0,352
TUB-0030	TR19.05X3.18	19,05	12,70	3,18	0,429
72-374C	TR19.05X6.35	19,05	6,35	6,35	0,686
72-319C	TR19.80X5.80	19,80	8,25	5,80	0,689
72-269	TR19.90X1.20	19,90	17,50	1,20	0,191
72-380C	TR20.00X1.50	20,00	17,00	1,50	0,236
72-286C	TR20.00X1.80	20,00	16,40	1,80	0,278
72-146	TR20.00X5.50	20,00	9,00	5,50	0,679
72-165	TR20.50X2.40	20,50	15,70	2,40	0,370
72-251	TR20.70X5.00	20,70	10,70	5,00	0,668
TUB-0366	TR21.00X1.50	21,00	18,00	1,50	0,249
72-332C	TR21.30X3.73	21,30	13,84	3,73	0,557
72-103	TR21.30X3.75	21,30	13,80	3,75	0,558
TUB-0034	TR21.34X2.77	21,34	15,80	2,77	0,436
72-326C	TR21.60X1.23	21,60	19,14	1,23	0,213
72-260	TR21.60X1.58	21,60	18,44	1,58	0,269
72-015	TR21.90X1.95	21,90	18,00	1,95	0,330
72-004	TR22.10X1.67	22,10	18,76	1,67	0,290

Profile	New Profile	Diameter Ø _e (mm)	Diameter Ø _i (mm)	Thickness E (mm)	Weight (Kg/m)
72-298C	TR22.20X1.23	22,20	19,75	1,23	0,218
72-064	TR22.20X2.20	22,20	17,80	2,20	0,373
72-297C	TR22.20X2.38	22,20	17,50	2,38	0,402
TUB-0036	TR22.22X1.00	22,22	20,22	1,00	0,180
TUB-0037	TR22.22X1.24	22,22	19,74	1,24	0,221
72-314C	TR22.22X1.50	22,22	19,22	1,50	0,264
TUB-0038	TR22.22X1.59	22,22	19,04	1,59	0,278
TUB-0041	TR22.22X3.00	22,22	16,22	3,00	0,512
72-333C	TR22.35X1.00	22,35	20,35	1,00	0,181
72-270	TR22.40X1.00	22,40	20,40	1,00	0,182
72-121	TR22.40X5.85	22,40	10,70	5,85	0,830
72-351C	TR23.20X4.10	23,20	15,00	4,10	0,667
72-382C	TR23.30X6.65	23,30	10,00	6,65	0,943
72-391C	TR23.50X3.00	23,50	17,50	3,00	0,524
TUB-176	TR24.00X2.50	24,00	19,00	2,50	0,457
72-227	TR24.50X6.00	24,50	12,50	6,00	0,945
72-304C	TR25.00X1.58	25,00	21,84	1,58	0,315
72-352C	TR25.00X2.00	25,00	21,00	2,00	0,392
72-366C	TR25.00X2.40	25,00	20,20	2,40	0,462
72-047	TR25.00X3.85	25,00	17,30	3,85	0,690
72-283C	TR25.20X1.00	25,20	23,20	1,00	0,206
72-291C	TR25.25X3.10	25,25	19,00	3,10	0,588
TUB-0044	TR25.40X1.00	25,40	23,40	1,00	0,206
TUB-0045	TR25.40X1.24	25,40	22,92	1,24	0,255
72-241	TR25.40X1.50	25,40	22,40	1,50	0,305
TUB-0046	TR25.40X1.59	25,40	22,22	1,59	0,322
TUB-0222	TR25.40X2.00	25,40	21,40	2,00	0,398
TUB-0047	TR25.40X2.40	25,40	20,60	2,40	0,466
72-266	TR25.40X2.60	25,40	20,20	2,60	0,504
TUB-0048	TR25.40X3.18	25,40	19,04	3,18	0,601
72-390C	TR25.40X3.70	25,40	18,00	3,70	0,684
72-127	TR25.40X6.55	25,40	12,30	6,55	1,047
72-385C	TR26.00X1.50	26,00	23,00	1,50	0,313
72-080	TR26.70X2.20	26,70	22,30	2,20	0,457
TUB-0050	TR26.67X2.87	26,67	20,93	2,87	0,579
72-350C	TR27.00X4.50	27,00	18,00	4,50	0,862
72-028	TR28.00X1.10	28,00	25,80	1,10	0,250
72-359C	TR28.50X7.00	28,50	14,50	7,00	1,281
72-360C	TR28.57X3.97	28,57	20,63	3,97	0,831
72-276C	TR28.58X1.00	28,58	26,59	1,00	0,232
TUB-0053	TR28.58X1.58	28,58	25,42	1,58	0,363
72-367C	TR28.58X2.54	28,58	23,50	2,54	0,563
72-222	TR30.00X3.50	30,00	23,00	3,50	0,789
72-161	TR30.00X4.50	30,00	21,00	4,50	0,977
72-098	TR30.00X5.10	30,00	19,80	5,10	1,077
72-342C	TR30.00X6.30	30,00	17,50	6,30	1,270
72-310C	TR30.00X6.90	30,00	16,20	6,90	1,357
72-282C	TR31.60X1.03	31,60	29,55	1,03	0,266
TUB-461	TR31.75X1.00	31,75	29,75	1,00	0,262
72-364C	TR31.75X1.20	31,75	29,35	1,20	0,312

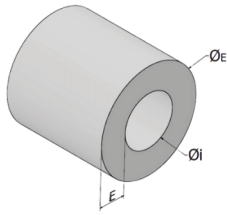

ROUND TUBE

Profile	New Profile	Diameter Ø _e (mm)	Diameter Ø _i (mm)	Thickness E (mm)	Weight (Kg/m)
TUB-0058	TR31.75X1.59	31,75	28,57	1,59	0,408
TUB-0060	TR31.75X2.38	31,75	26,99	2,38	0,592
TUB-0580	TR31.75X3.05	31,75	25,65	3,05	0,745
TUB-0061	TR31.75X3.17	31,75	25,41	3,17	0,770
TUB-0059	TR31.80X2.00	31,80	27,80	2,00	0,506
72-353C	TR32.00X5.75	32,00	20,50	5,75	1,285
72-339C	TR32.50X5.40	32,50	21,70	5,40	1,250
72-091	TR33.30X6.75	33,30	19,80	6,75	1,520
72-126	TR33.40X2.60	33,40	28,20	2,60	0,679
TUB-0066	TR33.00X3.38	33,40	26,64	3,38	0,860
TUB-067	TR33.40X4.55	33,40	24,30	4,55	1,118
TUB-651C	TR34.50X8.90	34,50	16,70	8,90	1,939
72-325C	TR34.70X1.35	34,70	32,00	1,35	0,383
72-072	TR34.70X1.85	34,70	31,00	1,85	0,515
72-073	TR34.70X2.85	34,70	29,00	2,85	0,770
72-329C	TR34.70X11.95	34,70	10,80	11,95	2,314
TUB-653C	TR34.92X3.17	34,92	28,58	3,17	0,856
72-133	TR35.00X1.50	35,00	32,00	1,50	0,426
TUB-407	TR35.00X2.00	35,00	31,00	2,00	0,561
72-312C	TR35.00X5.00	35,00	25,00	5,00	1,130
72-381C	TR35.00X6.00	35,00	23,00	6,00	1,481
72-340C	TR36.00X6.25	36,00	23,50	6,25	1,590
72-295C	TR38.10X1.10	38,10	35,90	1,10	0,346
72-265	TR38.10X1.30	38,10	35,50	1,30	0,407
TUB-0069	TR38.10X1.50	38,10	35,10	1,50	0,467
72-055	TR38.10X2.00	38,10	34,10	2,00	0,612
TUB-0215	TR38.10X2.38	38,10	33,34	2,38	0,721
72-233	TR38.10X2.60	38,10	32,90	2,60	0,785
TUB-0070	TR38.10X3.18	38,10	31,75	3,18	0,940
72-210	TR38.10X6.75	38,10	24,60	6,75	1,802
72-292C	TR38.10X7.05	38,10	24,00	7,05	1,863
72-285C	TR38.20X1.55	38,20	35,10	1,55	0,483
72-320C	TR38.40X1.10	38,40	36,20	1,10	0,349
72-354C	TR38.50X6.00	38,50	26,50	6,00	1,660
72-156	TR39.20X1.60	39,20	36,00	1,60	0,512
72-267	TR40.00X2.60	40,00	34,80	2,60	0,827
72-263	TR41.50X7.40	41,50	26,70	7,40	2,148
72-205	TR42.00X7.00	42,00	28,00	7,00	2,085
TUB-0075	TR42.17X3.56	42,17	35,05	3,56	1,165
TUB-0471	TR42.20X4.50	42,20	33,20	4,50	1,444
72-102	TR42.80X7.90	42,80	27,00	7,90	2,338
72-344C	TR43.50X6.75	43,50	30,00	6,75	2,112
TUB-0081	TR44.45X1.58	44,45	41,29	1,58	0,576
72-207	TR44.45X3.17	44,45	38,11	3,17	1,114
72-142	TR44.73X1.72	44,73	41,29	1,72	0,630
TUB-0257	TR45.00X2.00	45,00	41,00	2,00	0,732
72-328C	TR46.40X12.85	46,40	20,70	12,85	3,670
72-155	TR47.60X9.15	47,60	29,30	9,15	3,000
TUB-0088	TR48.26X3.68	48,26	40,90	3,68	1,396
TUB-0089	TR48.26X5.08	48,26	38,10	5,08	1,868

Profile	New Profile	Diameter Ø _e (mm)	Diameter Ø _i (mm)	Thickness E (mm)	Weight (Kg/m)
72-262	TR48.50X7.35	48,50	33,80	7,35	2,574
72-261	TR48.50X8.25	48,50	32,00	8,25	2,827
72-257	TR50.00X2.00	50,00	46,00	2,00	0,817
72-169	TR50.80X1.27	50,80	48,26	1,27	0,533
TUB-0609	TR50.80X1.45	50,80	47,90	1,45	0,609
72-185	TR50.80X1.60	50,80	47,60	1,60	0,670
72-213	TR50.80X1.65	50,80	47,50	1,65	0,690
TUB-0091	TR50.80X2.00	50,80	46,80	2,00	0,827
72-264	TR50.80X3.00	50,80	44,80	3,00	1,220
TUB-0092	TR50.80X3.18	50,80	44,44	3,18	1,289
72-236	TR50.80X4.00	50,80	42,80	4,00	1,593
72-252	TR50.80X6.35	50,80	38,10	6,35	2,403
72-271	TR50.80X8.05	50,80	34,70	8,05	2,929
TUB-652C	TR53.00X9.60	53,00	33,80	9,60	3,547
72-268	TR55.00X1.70	55,00	51,60	1,70	0,771
72-182	TR55.00X2.00	55,00	51,00	2,00	0,902
72-287D	TR55.00X2.44	55,00	50,13	2,44	1,090
72-180	TR55.00X6.00	55,00	43,00	6,00	2,503
72-099	TR55.50X9.90	55,50	35,70	9,90	3,830
72-183	TR57.20X2.38	57,20	52,44	2,38	1,110
72-228	TR58.40X10.80	58,40	36,80	10,80	4,380
72-232	TR60.00X1.50	60,00	57,00	1,50	0,747
72-197	TR60.00X2.00	60,00	56,00	2,00	0,987
72-105	TR60.00X4.50	60,00	51,00	4,50	2,118
72-154	TR60.00X5.00	60,00	50,00	5,00	2,341
72-186	TR60.30X2.50	60,30	55,30	2,50	1,230
TUB-0100	TR60.33X3.91	60,33	52,51	3,91	1,878
TUB-0101	TR60.33X5.54	60,33	49,25	5,54	2,584
TUB-602	TR60.33X8.71	60,33	42,91	8,71	3,829
72-358C	TR60.32X10.32	60,32	39,68	10,32	4,393
72-253	TR60.69X1.82	60,69	57,05	1,82	0,912
72-327C	TR62.00X2.00	62,00	58,00	2,00	1,021
72-246	TR62.00X11.00	62,00	40,00	11,00	4,776
TUB-156	TR63.00X1.50	63,00	60,00	1,50	0,782
72-243	TR63.00X1.80	63,00	59,40	1,80	0,937
72-189	TR63.50X1.60	63,50	60,30	1,60	0,843
72-081	TR63.50X1.65	63,50	60,20	1,65	0,865
72-198	TR63.50X1.70	63,50	60,10	1,70	0,894
72-158	TR63.50X2.50	63,50	58,50	2,50	1,298
72-223	TR63.50X3.05	63,50	57,40	3,05	1,569
72-148	TR63.50X3.18	63,50	57,14	3,18	1,633
72-101	TR63.50X11.25	63,50	41,00	11,25	4,985
72-040	TR64.00X2.00	64,00	60,00	2,00	1,051
72-194	TR64.00X8.50	64,00	47,00	8,50	4,016
72-008	TR65.00X1.50	65,00	62,00	1,50	0,811
72-336C	TR65.00X2.00	65,00	61,00	2,00	1,072
72-322C	TR65.00X9.50	65,00	46,00	9,50	4,488
72-118	TR65.00X10.85	65,00	43,30	10,85	4,984
72-211	TR66.00X1.50	66,00	63,00	1,50	0,823
72-106	TR67.00X9.50	67,00	48,00	9,50	4,633

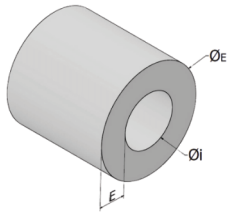

ROUND TUBE

Profile	New Profile	Diameter Ø _e (mm)	Diameter Ø _i (mm)	Thickness E (mm)	Weight (Kg/m)
72-093	TR69.85X3.17	69,85	63,51	3,17	1,792
72-014	TR70.00X1.50	70,00	67,00	1,50	0,871
72-195	TR70.00X2.00	70,00	66,00	2,00	1,157
72-009	TR70.00X3.00	70,00	64,00	3,00	1,711
72-120	TR70.00X3.50	70,00	63,00	3,50	1,981
72-179	TR70.00X6.00	70,00	58,00	6,00	3,269
72-104	TR70.00X11.75	70,00	46,50	11,75	5,805
72-277C	TR73.00X2.00	73,00	69,00	2,00	1,208
72-275	TR73.00X3.00	73,00	67,00	3,00	1,787
TUB-0109	TR73.03X5.16	73,03	62,71	5,16	2,981
TUB-0110	TR73.03X7.01	73,03	59,01	7,01	3,925
72-307C	TR75.00X2.00	75,00	71,00	2,00	1,242
TUB-0324	TR76.20X1.27	76,20	73,66	1,27	0,807
72-163	TR76.20X1.58	76,20	73,04	1,58	1,004
72-201	TR76.20X1.70	76,20	72,80	1,70	1,078
72-206	TR76.20X2.00	76,20	72,20	2,00	1,263
72-324C	TR76.20X2.35	76,20	71,50	2,35	1,477
72-159	TR76.20X2.50	76,20	71,20	2,50	1,569
TUB-0167	TR76.20X3.00	76,20	70,20	3,00	1,869
72-117	TR76.20X3.18	76,20	69,85	3,18	1,966
72-302C	TR76.20X5.60	76,20	65,00	5,60	3,365
TUB-604	TR76.20X11.10	76,20	54,00	11,10	6,152
72-248	TR77.00X2.00	77,00	73,00	2,00	1,277
TUB-0157	TR80.00X1.60	80,00	76,80	1,60	1,067
72-010	TR80.00X2.00	80,00	76,00	2,00	1,323
72-330C	TR80.00X2.50	80,00	75,00	2,50	1,649
72-090	TR80.00X8.00	80,00	64,00	8,00	4,885
72-219	TR82.00X2.50	82,00	77,00	2,50	1,692
72-331C	TR83.80X8.00	83,80	67,80	8,00	5,162
TUB-248	TR84.60X4.00	84,60	76,60	4,00	2,734
72-281C	TR88.90X2.00	88,90	84,90	2,00	1,479
TUB-0117	TR88.90X5.50	88,90	77,90	5,50	3,898
72-355C	TR88.90X6.35	88,90	76,20	6,35	4,463
TUB-0118	TR88.90X7.62	88,90	73,66	7,62	5,273
72-187	TR90.00X2.00	90,00	86,00	2,00	1,498
72-137	TR90.00X3.00	90,00	84,00	3,00	2,222
72-250	TR91.00X5.50	91,00	80,00	5,50	4,003
72-296C	TR95.00X4.00	95,00	87,00	4,00	3,098
72-316C	TR95.00X17.00	95,00	61,00	17,00	11,289
72-240	TR97.20X3.50	97,20	90,20	3,50	2,792
72-256	TR98.90X3.65	98,90	91,60	3,65	2,960
72-299C	TR100.00X1.50	100,00	97,00	1,50	1,257
72-200	TR100.00X2.00	100,00	96,00	2,00	1,668
72-168	TR100.00X7.00	100,00	86,00	7,00	5,547
TUB-0337	TR101.60X1.20	101,60	99,20	1,20	1,025
72-190	TR101.60X1.58	101,60	98,40	1,58	1,345
72-239	TR101.60X2.00	101,60	97,60	2,00	1,695
TUB-0182	TR101.60X2.60	101,60	96,40	2,60	2,191
72-238	TR101.60X6.35	101,60	88,90	6,35	5,149

Profile	New Profile	Diameter Ø _e (mm)	Diameter Ø _i (mm)	Thickness E (mm)	Weight (Kg/m)
TUB-0649	TR101.60X3.17	101,60	95,26	3,17	2,656
TUB-0122	TR101.60X5.74	101,60	90,12	5,74	4,791
TUB-0123	TR101.60X8.08	101,60	85,44	8,08	6,433
72-365C	TR103.90X3.00	103,90	97,90	3,00	3,000
TUB-0362	TR105.00X3.50	105,00	98,00	3,50	3,024
72-218	TR107.90X3.00	107,90	101,90	3,00	2,679
72-273	TR107.95X3.43	107,95	101,10	3,43	3,047
72-318D	TR108.50X4.25	108,50	100,00	4,25	3,772
72-171	TR110.00X1.70	110,00	106,60	1,70	1,567
72-176	TR110.00X2.50	110,00	105,00	2,50	2,288
72-259	TR110.00X3.50	110,00	103,00	3,50	3,173
72-323C	TR114.30X3.05	114,30	108,20	3,05	2,888
72-284C	TR114.30X3.85	114,30	106,60	3,85	3,620
TUB-0125	TR114.30X6.02	114,30	102,26	6,02	5,549
72-369C	TR114.30X7.94	114,30	98,42	7,94	7,190
TUB-0127	TR114.30X8.56	114,30	97,18	8,56	7,706
TUB-0137	TR114.30X9.53	114,30	95,24	9,53	8,500
TUB-0610	TR114.30X11.10	114,30	92,10	11,10	9,752
TUB-0611	TR114.30X13.49	114,30	87,33	13,49	11,574
72-249	TR120.00X1.70	120,00	116,60	1,70	1,712
72-217	TR120.00X3.50	120,00	113,00	3,50	3,471
72-346D	TR120.00X6.00	120,00	108,00	6,00	5,824
72-345D	TR120.00X11.00	120,00	98,00	11,00	10,208
72-202	TR127.00X3.00	127,00	121,00	3,00	3,167
72-347D	TR127.00X3.18	127,00	120,64	3,18	3,352
TUB-0129	TR127.00X6.27	127,00	114,46	6,27	6,444
72-335C	TR127.00X8.50	127,00	110,00	8,50	8,575
TUB-0131	TR127.00X9.01	127,00	108,98	9,01	9,050
TUB-0613	TR141.30X3.40	141,30	134,50	3,40	3,991
TUB-0132	TR141.30X6.55	141,30	128,20	6,55	7,514
TUB-133	TR141.30X9.52	141,30	122,26	9,52	10,680
72-258	TR150.00X4.00	144,00	137,80	3,10	3,718
72-221	TR150.00X4.00	150,00	142,00	4,00	4,972
72-317D	TR152.40X1.60	152,40	149,20	1,60	2,054
72-387D	TR152.40X2.40	152,40	147,60	2,40	3,065
72-294D	TR152.40X3.18	152,40	146,04	3,18	4,033
72-349C	TR154.00X19.00	154,00	116,00	19,00	21,838
72-356C	TR159.00X3.30	159,00	152,40	3,30	4,374
72-398D	TR160.00X3.20	160,00	153,60	3,20	4,271
72-357C	TR163.00X5.30	163,00	152,40	5,30	7,116
72-389C	TR168.00X4.75	168,00	158,50	4,75	6,602
TUB-136	TR168.20X10.97	168,20	146,26	10,97	14,684
TUB-0135	TR168.28X7.11	168,28	154,06	7,11	9,756
72-384E	TR168.28X10.98	168,28	146,33	10,98	14,698
72-305D	TR178.00X14.50	178,00	149,00	14,50	20,183
72-371E	TR200.00X10.00	200,00	180,00	10,00	16,176
72-363E	TR203.20X1.90	203,20	199,40	1,90	3,256
TUB-650C	TR219.10X8.20	219,10	202,70	8,20	14,687
72-362E	TR244.00X22.00	244,00	200,00	22,00	41,581

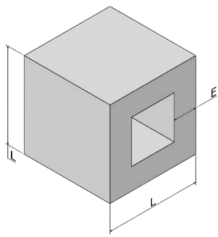

SQUARE TUBE

SHARP CORNER WITH A RADIUS OF UP TO 0,5MM

Profile	New Profile	Width L (mm)	Thickness E (mm)	Weight (Kg/m)
73-018C	TQ10.00X1.50	10,00	1,50	0,138
73-005	TQ12.70X1.58	12,70	1,58	0,189
TUB-4001	TQ12.70X1.65	12,70	1,65	0,196
TUB-4002	TQ15.90X1.50	15,90	1,50	0,233
TUB-4038	TQ19.00X1.20	19,00	1,20	0,231
TUB-4003	TQ19.05X1.50	19,05	1,50	0,285
73-029C	TQ19.10X1.10	19,10	1,10	0,214
73-041C	TQ20.00X1.20	20,00	1,20	0,245
73-003	TQ22.22X1.30	22,22	1,30	0,293
73-015C	TQ25.40X1.00	25,40	1,00	0,264
TUB-4007	TQ25.40X1.20	25,40	1,20	0,314
TUB-4008	TQ25.40X1.50	25,40	1,50	0,389
73-024C	TQ25.40X2.00	25,40	2,00	0,507
TUB-4051	TQ25.40X3.17	25,40	3,17	0,763
73-044C	TQ30.00X2.00	30,00	2,00	0,607
TUB-4046	TQ30.00X4.00	30,00	4,00	1,127
TUB-4011	TQ31.75X1.50	31,75	1,50	0,492
73-036C	TQ31.75X2.00	31,75	2,00	0,645
73-032C	TQ31.75X3.18	31,75	3,18	0,985
73-045C	TQ38.00X2.00	38,00	2,00	0,780
73-020C	TQ38.10X1.00	38,10	1,00	0,402
73-027C	TQ38.10X1.20	38,10	1,20	0,480
TUB-4014	TQ38.10X1.50	38,10	1,50	0,595
73-023C	TQ40.00X2.00	40,00	2,00	0,823
73-022C	TQ40.00X3.00	40,00	3,00	1,203

Profile	New Profile	Width L (mm)	Thickness E (mm)	Weight (Kg/m)
73-043C	TQ42.00X2.00	42,00	2,00	0,867
73-008	TQ44.45X2.68	44,45	2,68	1,211
73-021C	TQ50.00X3.00	50,00	3,00	1,528
73-011	TQ50.00X5.00	50,00	5,00	2,439
73-026C	TQ50.80X1.30	50,80	1,30	0,700
74-050C	TQ50.80X1.80	50,80	1,80	0,956
TUB-4020	TQ50.80X2.00	50,80	2,00	1,057
73-006	TQ50.80X3.00	50,80	3,00	1,554
TUB-4048	TQ50.80X3.18	50,80	3,18	1,635
73-001	TQ50.80X6.35	50,80	6,35	3,050
73-004	TQ60.00X3.50	60,00	3,50	2,123
73042C	TQ63.50X6.35	63,50	6,35	3,934
TUB-4030	TQ65.00X2.00	65,00	2,00	1,365
73-030C	TQ75.00X1.40	75,00	1,40	1,117
73-016C	TQ76.20X2.00	76,20	2,00	1,608
TUB-4067	TQ76.20X3.17	76,20	3,17	2,509
TUB-4034	TQ80.00X1.80	80,00	1,80	1,525
73-034C	TQ80.00X4.00	80,00	4,00	3,295
73-028C	TQ88.90X1.40	88,90	1,40	1,328
73-014D	TQ101.60X1.70	101,60	1,70	1,840
TUB-4054	TQ101.60X2.50	101,60	2,50	2,675
73-040D	TQ120.00X2.50	120,00	2,50	3,184
73-025E	TQ152.40X2.50	152,40	2,50	4,062
73-039E	TQ152.40X3.80	152,40	3,80	6,121

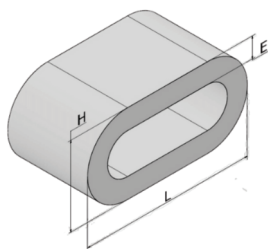

OVAL TUBE

Profile	New Profile	Width L (mm)	Height H (mm)	Thickness E (mm)	Weight (Kg/m)
MG16-350	TO15.00X8.00X1.00	15,00	8,00	1,00	0,097
75-023C	TO25.00X15.00X2.00	25,00	15,00	2,00	0,330
78-1506C	TO29.50X18.00X1.20	29,50	18,00	1,20	0,246
75-009	TO30.00X12.00X1.40	30,00	12,00	1,40	0,265
78-1706C	TO30.00X15.00X1.50	30,00	15,00	1,50	0,294
75-003	TO35.00X20.00X1.50	35,00	20,00	1,50	0,357

Profile	New Profile	Width L (mm)	Height H (mm)	Thickness E (mm)	Weight (Kg/m)
75-008	TO50.00X12.00X1.50	50,00	12,00	1,50	0,443
78-300	TO58.00X29.00X2.00	58,00	29,00	2,00	0,771
78-857	TO100.00X33.00X1.40	100,00	33,00	1,40	0,885
78-1596C	TO108.00X21.00X2.00	108,00	21,00	2,00	1,266
78-1027	TO109.00X22.00X2.50	109,00	22,00	2,50	1,593

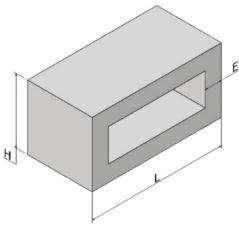

RECTANGULAR TUBE

SHARP CORNER WITH A RADIUS OF UP TO 0,5MM

Profile	New Profile	Width L (mm)	Height H (mm)	Thickness E (mm)	Weight (Kg/m)
74-021	TG20.00X12.00X1.50	20,00	12,00	1,50	0,235
74-032	TG25.40X12.70X1.00	25,40	12,70	1,00	0,195
TUB-4584	TG25.40X12.70X1.58	25,40	12,70	1,58	0,299
TUB-4501	TG25.40X12.70X1.65	25,40	12,70	1,65	0,311
74-009	TG28.00X9.00X1.40	28,00	9,00	1,40	0,258
74-041C	TG30.00X10.00X1.50	30,00	10,00	1,50	0,300
TUB-4509	TG30.00X20.00X2.00	30,00	20,00	2,00	0,497
74-034C	TG36.00X20.00X1.30	36,00	20,00	1,30	0,375
74-016	TG38.10X25.40X1.20	38,10	25,40	1,20	0,397
74-037C	TG38.10X25.40X1.58	38,10	25,40	1,58	0,516
TUB-4545	TG38.10X25.40X2.00	38,10	25,40	2,00	0,642
74-028	TG40.00X20.00X1.50	40,00	20,00	1,50	0,463
74-054C	TG40.00X20.00X3.00	40,00	20,00	3,00	0,878
78-1931C	TG45.00X35.00X2.00	45,00	35,00	2,00	0,823
74-005	TG46.00X23.00X1.00	46,00	23,00	1,00	0,363
74-008	TG50.00X30.00X2.00	50,00	30,00	2,00	0,821
74-056C	TG50.00X38.10X3.00	50,00	38,10	3,00	1,334
74-045C	TG50.80X12.70X1.00	50,80	12,70	1,00	0,333
TUB-4536	TG50.80X12.70X1.50	50,80	12,70	1,50	0,492
74-001	TG50.80X25.40X1.00	50,80	25,40	1,00	0,402
TUB-4563	TG50.80X25.40X1.20	50,80	25,40	1,20	0,479
TUB-4569	TG50.80X25.40X1.60	50,80	25,40	1,60	0,630
TUB-4504	TG50.80X25.40X2.00	50,80	25,40	2,00	0,780
74-020	TG50.80X38.10X1.58	50,80	38,10	1,58	0,734
TUB-4513	TG50.80X38.10X2.00	50,80	38,10	2,00	0,920
74-022	TG53.00X9.50X1.40	53,00	9,50	1,40	0,452
74-015	TG60.30X38.10X1.40	60,30	38,10	1,40	0,725
TUB-4543	TG60.30X38.10X1.70	60,30	38,10	1,70	0,870
74-069C	TG60.30X38.10X2.00	60,30	38,10	2,00	1,023
74-006	TG72.00X35.00X1.40	72,00	35,00	1,40	0,790
74-023	TG76.20X25.40X1.58	76,20	25,40	1,58	0,842

Profile	New Profile	Width L (mm)	Height H (mm)	Thickness E (mm)	Weight (Kg/m)
74-067C	TG76.20X25.40X2.00	76,20	25,40	2,00	1,058
74-059C	TG76.20X38.10X1.30	76,20	38,10	1,30	0,790
74-002	TG76.20X38.10X1.50	76,20	38,10	1,50	0,904
TUB-4517	TG76.20X38.10X2.00	76,20	38,10	2,00	1,196
TUB-4518	TG76.20X38.10X3.00	76,20	38,10	3,00	1,780
TUB-4573	TG76.20X50.80X3.20	76,20	50,80	3,20	2,079
74-065C	TG80.00X40.00X4.00	80,00	40,00	4,00	2,432
74-027	TG80.00X40.00X5.00	80,00	40,00	5,00	2,981
74-047C	TG80.00X60.00X2.00	80,00	60,00	2,00	1,474
74-004	TG83.90X57.15X3.17	83,90	57,15	3,17	2,300
74-044C	TG100.00X30.00X3.00	100,00	30,00	3,00	2,016
74-040C	TG100.00X40.00X1.50	100,00	40,00	1,50	1,113
74-055C	TG100.00X60.00X4.00	100,00	60,00	4,00	3,295
74-018	TG101.60X25.40X3.18	101,60	25,40	3,18	2,076
TUB-4537	TG101.60X38.10X2.40	101,60	38,10	2,40	1,754
74-060C	TG101.60X50.80X1.50	101,60	50,80	1,50	1,220
74-024	TG101.60X50.80X1.60	101,60	50,80	1,60	1,293
74-053C	TG101.60X50.80X2.40	101,60	50,80	2,40	1,919
74-003	TG101.60X50.80X2.00	101,60	50,80	2,00	1,602
TUB-4530	TG101.60X50.80X3.05	101,60	50,80	3,05	2,418
74-014	TG101.60X50.80X4.60	101,60	50,80	4,60	3,570
74-035C	TG118.00X45.00X3.00	118,00	45,00	3,00	2,552
74-048C	TG125.00X80.00X2.00	125,00	80,00	2,00	2,178
TUB-4600	TG127.00X50.80X3.17	127,00	50,80	3,17	2,945
74-036C	TG152.40X38.10X2.00	152,40	38,10	2,00	2,021
TUB-4520	TG152.40X38.10X3.20	152,40	38,10	3,20	3,193
74080C	TG152.40X50.80X3.00	152,40	50,80	2,00	2,163
TUB-4559	TG152.40X50.80X3.00	152,40	50,80	3,00	3,206
78-2141D	TG200.00X50.00X2.00	200,00	50,00	2,00	2,667
78-2140D	TG250.00X50.00X2.50	250,00	50,00	2,50	3,997

asa

alumínio



Scan the QRcode and
access our website!